

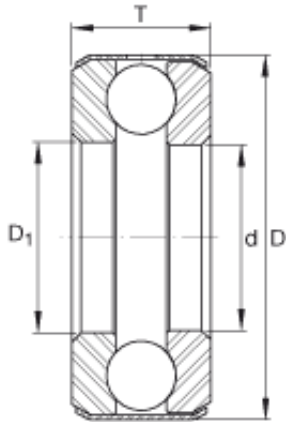

Bearing Manufacturing of America



INA D8 thrust ball bearings

Bearing No. D8

D8 Bearing 2D drawings and 3D CAD models

Size	23.813x46.838x15.875 mm
Bore Diameter	23,813 mm
Outer Diameter	46,838 mm
Width	15,875 mm
d	15/16 inch
d	23,813 mm
D	1,844 inch
D	46,838 mm
T	0,625 inch
T	15,875 mm
D ₁	0,969 inch
m	0,27 lbs / Weight
m	122 g / Weight
C _a	6600 lbf / Dynamic load rating (axial)
C _a	29400 N / Dynamic load rating (axial)
C _{0a}	12200 lbf / Static load rating (axial)
C _{0a}	54000 N / Static load rating (axial)
Category	Thrust Ball Bearing
Inventory	0.0
Manufacturer Name	SCHAEFFLER GROUP
Minimum Buy Quantity	N/A
Weight / Kilogram	0.12
EAN	4012802034738



Bearing Manufacturing of America

Product Group	B04270
Rolling Element	Ball Bearing
Thrust Bearing	Yes
Single or Double Direction	Single Direction
Banded	Yes
Precision Class	ABEC 1 ISO P0
Component Description	Roller Assembly Plus Raceways
Other Features	Single Row Deep Groove Medium Cross Section Grooved Race Non Separable Full Complement Standard Oil Hole in Band
Long Description	15/16" Bore 1; 31/32" Bore 2; 1-27/32" Outside Diameter; 5/8" Height; Ball Bearing; Single Direction; Banded; ABEC 1 ISO P0 Precision
Inch - Metric	Inch
Category	Thrust Ball Bearings
UNSPSC	31171507
Harmonized Tariff Code	8482.10.50.08
Noun	Bearing
Keyword String	Ball Thrust
Manufacturer URL	http://www.ina.com
Manufacturer Item Number	D8
Weight / LBS	0.27
Overall Height with Aligning Washer	0 Inch 0 Millimeter
Bore 1	0.938 Inch 23.825 Millimeter
Height	0.625 Inch 15.875 Millimeter
Outside Diameter	1.844 Inch 46.838 Millimeter



Bearing Manufacturing of America

Bore 2

0.969 Inch | 24.613
Millimeter