

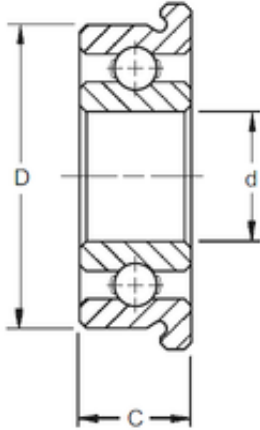

Bearing Manufacturing of America

20 mm x 32 mm x 7 mm 20 mm x 32 mm x 7 mm ZEN SF61804 deep groove ball bearings



Bearing No. SF61804

Size	20x32x7 mm
Bore Diameter	20 mm
Outer Diameter	32 mm
Width	7 mm
d	20 mm
D	32 mm
B	7 mm
C	7 mm
Basic dynamic load rating (C)	4,015 kN
Basic static load rating (C0)	2,462 kN
(Grease) Lubrication Speed	21000 r/min

SF61804 Bearing 2D drawings and 3D CAD models